

Raft foundations – edge detail

(January 2024) (Third issue – supersedes June 2022)

The Technical Guidance Notes are produced by NHBC as guidance solely for our builder customers as to how to interpret the technical requirements in relation to the warranty cover provided by NHBC under its Buildmark, Buildmark Choice, Buildmark Link, Buildmark Solo, Buildmark Connect or any similar product from time to time. It has not been created or intended for distribution or use outside of that purpose. The information contained in this Technical Guidance Note does not constitute advice and is not to be relied upon by any third party. Nothing in this Technical Guidance Note is intended to, nor should it be taken to, create any legal or contractual relationship. Any third party who chooses to rely upon the information contained in the Technical Guidance Notes shall do so entirely at their own risk and NHBC accepts no duty of care or liability, however caused, in connection with its use or reliance by any third party.

Question

Does a raft foundation slab require a ‘toe’ for support of the outer leaf of a cavity wall and to provide weather-proofing at the floor/wall junction (as shown in NHBC Standards clause 4.4.13)?

Considerations

- NHBC Standards clause 4.4.13 states ‘the foundation design shall prevent the passage of moisture to the inside of the home’ and shows how this can be achieved with a stepped edge on a raft foundation.
- NHBC Standards clause 4.4.13 refers to dpc cavity trays not being an acceptable method of weather-proofing the edges of specialist foundations such as rafts and ground beams. This is to avoid details where a failure of the stepped tray would lead to a direct leakage of water into the building.

Answer

Raft foundations can be accepted without a toe provided it can be shown that there is adequate weather-proofing at the junction of the wall and the raft.

The detail shown below is one acceptable method of achieving this. It uses a combination of a stepped cavity tray and dpm together with pre-formed corner trays and sealed lap joints.

Raft foundations – edge detail

(January 2024) (Third issue – supersedes June 2022)

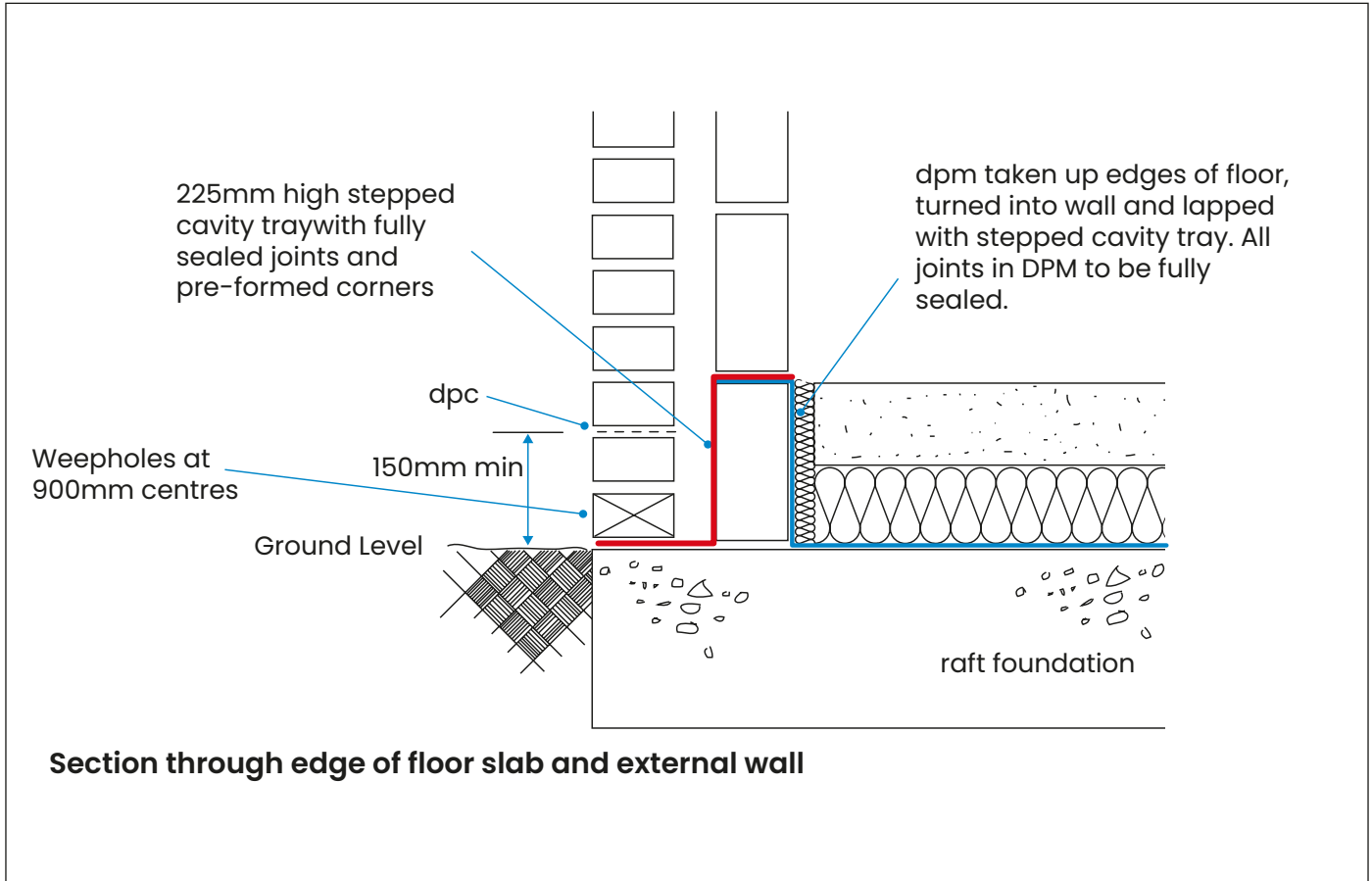

Figure 1 – Flat slab rafts (i.e. without downward toe) should only be placed on non-frost susceptible base or soil.